

## WHY IS JHS REQUESTING \$12,500,000?

Since 2019, Jefferson High School has been studying enrollment, demographics, the school's facilities conditions, and how to best serve the District's students and community. Through the process, it was determined that a \$12.5M bond will provide the funds to address all prioritized needs and have the most long-term benefit while keeping the cost to taxpayers as low as possible.

- Last school bond was in 1985 for the '85 library/gym/classroom addition.
- Accommodate increase in enrollment.
- Keep students in district in a smaller, more personalized educational setting.
- Address updates needed throughout school, but especially in: safety & security, classroom spaces & space for popular programs, accessibility, and mechanical/electrical/plumbing systems.
- Create a 21st Century Learning environment to keep up with changing technologies & teaching approaches.
- Providing benefits to all students and staff and holistic updates to all areas of the school will be accomplished by making improvements to academic, fine & performing arts, athletics, and Career and Technical Education areas.
- Create economic and community benefit: The school will be able to host track & field meets and other larger athletic events, bringing money to local businesses.
- Invest in the students, staff & community for long-term viability.
- Improve maintenance & utility savings of school facilities long-term.
- Improve accessibility throughout to school for students with mobility challenges.
- Improve safety & security throughout school.

## HOW MUCH WILL THIS COST ME?

1

Visit [HTTP://SVC.MT.GOV/DOR/PROPERTY/PRC](http://SVC.MT.GOV/DOR/PROPERTY/PRC) or hold up your camera app or QR scanner to the code and tap the pop up banner/notification to take you to the website.



2

Enter your property address to access your property's taxable value.

3

Calculate your estimated annual tax impact using the following formula and the mills from the table below:

$$\text{"TAXABLE VALUE"} \times \text{MILLS} / 1,000 = \text{ESTIMATED ANNUAL TAX IMPACT OF THE BONDS}$$

Estimated Mill Levy Computation		\$12,500,000 20 Year Term	
Per Amount		\$12,500,000	
Total Est. Interest Over Life of Bond (1):		\$5,230,750	
Est. Annual Bond Payment on Tax Rolls (1):		\$886,538	
Divided by District's 2020/21 Mill Value:		\$22,349,420	
EQUALS: Estimated Number of Mills Required		39.57	
Estimated Tax Increase for Individual Residential Taxpayer:			
2020/21 Tax Year "Market Value" of Residential Property	2020/21 Tax Year "Taxable Value" of Residential Property	Est. Annual Tax	Est. Month- ly Tax
\$100,000	\$1,350	\$53.55	\$4.46
\$200,000	\$2,700	\$107.10	\$8.93
\$300,000	\$4,050	\$160.65	\$13.39



FOLLOW JHS ON SOCIAL MEDIA TO LEARN MORE!

**Jefferson**  
HIGH SCHOOL



## Jefferson High School EXPANSION & SECURITY UPDATES BOND

Visit [jhs.k12.mt.us/Pre-BondPlanning.aspx](http://jhs.k12.mt.us/Pre-BondPlanning.aspx) for more information or call Jefferson High School at: 406-225-3740.

**LEARN MORE & VOTE  
BY NOVEMBER 2**

# WHAT IS INCLUDED IN THE PROPOSED BOND?

Jefferson High School is proposing a \$12.5M bond that will address needs throughout the school. The bond, if approved by the voters, will cover all construction, design and associated costs for the updates in addition to renovations & additions throughout the school's academic, Fine Arts and athletic areas.

## KEY

- NEW ADDITION
- RENOVATION / UPGRADES
- REPURPOSE FOR ANOTHER EDUCATIONAL USE

### CREATE SECURE VESTIBULE / NEW MAIN OFFICE + SAFETY & SECURITY UPGRADES SCHOOL-WIDE

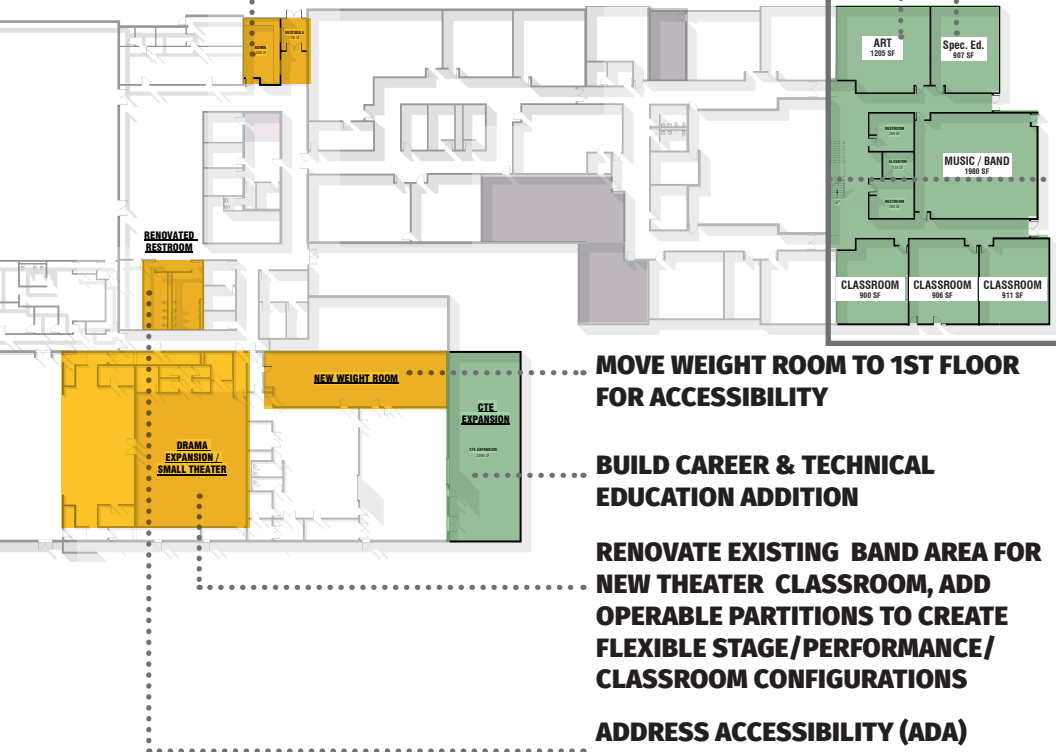

### MOVE WEIGHT ROOM TO 1ST FLOOR FOR ACCESSIBILITY

### BUILD CAREER & TECHNICAL EDUCATION ADDITION

### RENOVATE EXISTING BAND AREA FOR NEW THEATER CLASSROOM, ADD OPERABLE PARTITIONS TO CREATE FLEXIBLE STAGE/PERFORMANCE/CLASSROOM CONFIGURATIONS

### ADDRESS ACCESSIBILITY (ADA) NEEDS TO COMMONS RESTROOM & THROUGHOUT SCHOOL

#### FIRST FLOOR ADDITION

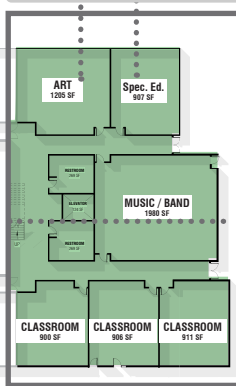

#### SECOND FLOOR ADDITION

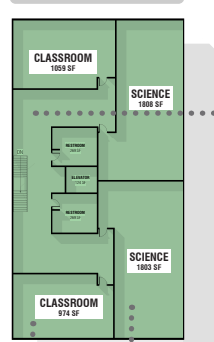

**NEW ART CLASSROOM**

### NEW SPECIAL EDUCATION SUITE



**NEW UPSTAIRS CIRCULATION**



**NEW SCIENCE CLASSROOMS**

### FIVE NEW GENERAL CLASSROOMS



**NEW SHARED SPACE/STAIR**

- All-mail election; ballots mailed October 14.
- Return to JHS District Clerk via mail or drop-off:  
Mail: Jefferson High School: P.O. Box 838, Boulder  
Drop-Off: during regular business hours at JHS, 312 South Main, Boulder (8am-4:30 pm M-F)

6,075 copies of this item were produced and distributed at a total cost of \$3,373 which includes \$1,843 for printing and \$1,530 for distribution.

- UPGRADE MECHANICAL/ELECTRICAL/PLUMBING THROUGHOUT SCHOOL
- UPDATE GROUNDS, ATHLETIC, AND TRACK & FIELD AREAS

RENDERINGS & CONCEPTUAL PLANNING BY:

